

45M EXPEDITION YACHT



PERSAK & WURMFELD
leading the next generation of yacht design & naval architecture

HAKVOORT
SHIPYARD



SPECIFICATIONS

DESCRIPTION

The following project has been developed in cooperation between **HAKVOORT SHIPYARDS** of Monnickendam, Netherlands, and naval architects **PERSAK & WURMFELD** of New York City.

The design boasts a bold, clean, sculptural exterior with a plum stemmed, sea kindly, and efficient hull form suitable for long range cruising and exploration. The interior arrangement offers versatility unlike any vessel in its size range, suitable for 12 guests in 6 staterooms.

The construction of the vessel will be at the highest level of yacht quality to the meticulous standards of the Hakvoort family, as well as the regulations of Lloyds and MCA.

Project Development
Exterior Design
Naval Architecture

HAKVOORT SHIPYARD
PERSAK & WURMFELD
PERSAK & WURMFELD

Hull Construction
Superstructure
Hull type

aluminum or steel
aluminum
semi displacement (aluminum hull)
displacement (steel hull)

Guests
Crew
Class
Flag
Gross Tonnage

12
8 + captain
+100A1 SSC Yacht Mono G6 (+)LMC UMS
MCA LY2
< 450 GT (aluminum hull)
< 500 GT (steel hull)

PRINCIPLE DIMENSIONS

Length, overall	147.42'	44.93 m
Length, waterline	147.42'	44.93 m
Beam, maximum	28.25'	8.61 m
Draft	8.50'	2.59 m
Fuel	18,500 gal	70,000 l
Water	2,600 gal	10,000 l

PERFORMANCE

STEEL HULL

Main engines	(2) x MTU 10V2000M72, 900kW each
Range, max	4,000nm
Speed, max	15 knots

ALUMINUM HULL

Main engines	(2) x MTU 12V2000M84, 1220kW each
Speed, max	19 knots
Main engines	(2) x MTU 16V2000M84, 1630kW each
Speed, max	21 knots

SPECIAL FEATURES

Sun deck: bar, jacuzzi, forward dining
Bridge deck: sky lounge, theater, sky gym, and VIP stateroom
Main deck: full beam Owners stateroom with balconies
Lower deck: (4) VIP staterooms, crew area forward
Foredeck: sunning and dining area
Tender bay: wide transom door, 23' tender, two jet skis

ARRANGEMENT

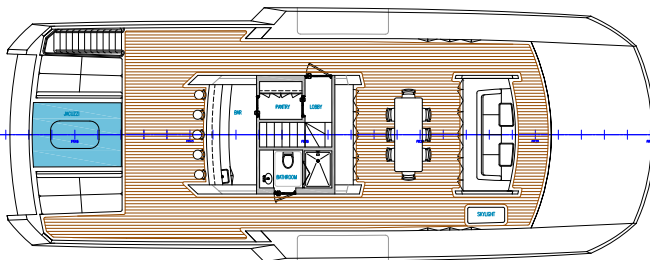

SUN DECK

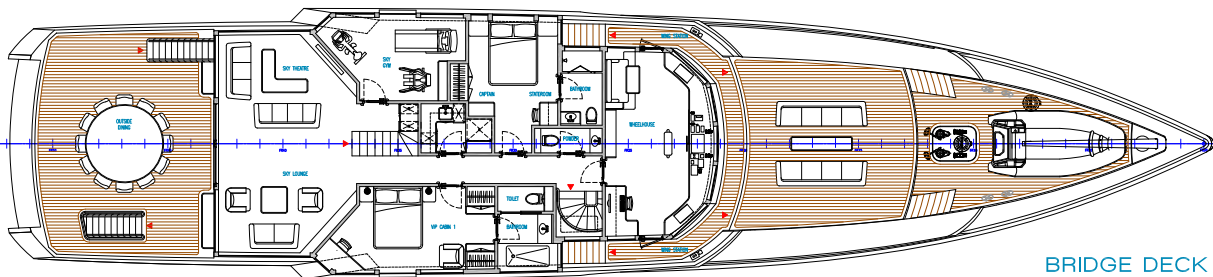

BRIDGE DECK

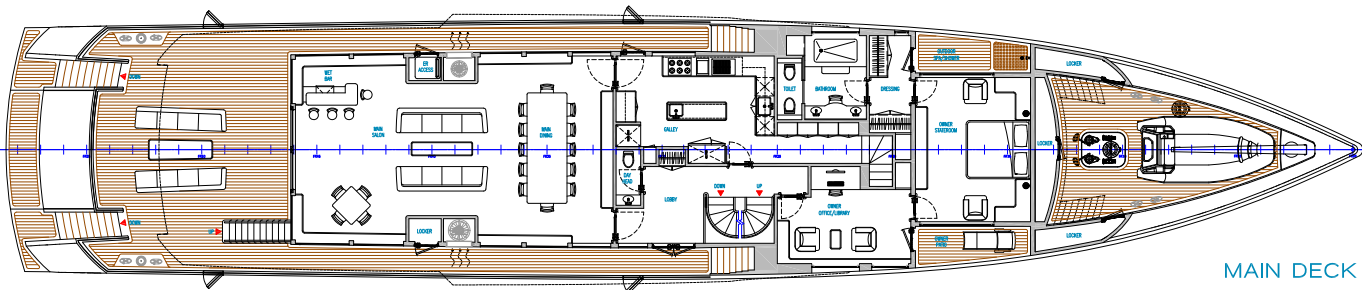

MAIN DECK

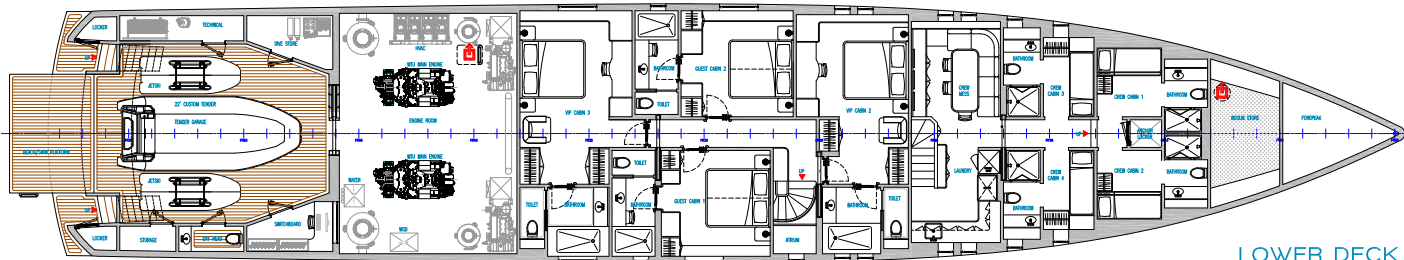

LOWER DECK



PERSAK & WURMFELD

leading the next generation of yacht design & naval architecture

68 jay street unit 411
brooklyn, ny, 11201 USA
p. +1.718.222.4401
f. +1.866.887.8487
www.persakwurmfeld.com

HAKVOORT SHIPYARD

havenstraat 22
1141 ax monnickendam, the netherlands
p. +31.299.651403
f. +31.299.651041
www.hakvoort.com